

MANUFACTURER AND STOCKIST OF FORGED  
STEEL FITTINGS AND BRANCH CONNECTIONS

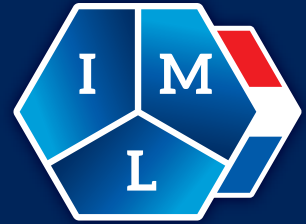

**IML Nederland**



## STOCK | DELIVERY PROGRAM



# STOCK | DELIVERY PROGRAM



IML Nederland

TYPE		SIZE 1	SIZE 2	CLASS	A105/N	A350 LF2	A182 F11/2	A182 F22/3	A182 F304/L	A182 F316/L	A182 F321/H	A182 F51
ELB. 90 DEGR.	SW	1/2"		3000#	1435	478	95	78	212	189	78	59
ELB. 90 DEGR.	SW	3/4"		3000#	1510	504	84	104	216	175	56	48
ELB. 90 DEGR.	SW	1"		3000#	2025	675	200	165	135	210	73	145
ELB. 90 DEGR.	SW	1.1/4"		3000#	293	98	√	√	53	43	√	√
ELB. 90 DEGR.	SW	1.1/2"		3000#	465	155	42	48	106	77	34	26
ELB. 90 DEGR.	SW	2"		3000#	298	98	21	23	52	43	22	12
ELB. 90 DEGR.	SW	1/2"		6000#	724	242	91	102	104	78	√	√
ELB. 90 DEGR.	SW	3/4"		6000#	735	248	106	108	111	95	√	√
ELB. 90 DEGR.	SW	1"		6000#	987	329	210	215	167	156	√	√
ELB. 90 DEGR.	SW	1.1/4"		6000#	83	28	√	√	√	√	√	√
ELB. 90 DEGR.	SW	1.1/2"		6000#	241	80	55	52	√	√	√	√
ELB. 90 DEGR.	SW	2"		6000#	97	32	28	23	√	√	√	√
ELB. 45 DEGR.	SW	1/2"		3000#	713	238	59	48	53	67	40	23
ELB. 45 DEGR.	SW	3/4"		3000#	724	242	48	47	58	78	52	25
ELB. 45 DEGR.	SW	1"		3000#	978	326	145	120	114	98	37	52
ELB. 45 DEGR.	SW	1.1/4"		3000#	78	26	√	√	32	23	√	√
ELB. 45 DEGR.	SW	1.1/2"		3000#	214	72	26	28	45	56	39	21
ELB. 45 DEGR.	SW	2"		3000#	134	44	12	9	28	32	24	11
ELB. 45 DEGR.	SW	1/2"		6000#	278	93	53	45	54	67	√	√
ELB. 45 DEGR.	SW	3/4"		6000#	315	105	47	48	58	69	√	√
ELB. 45 DEGR.	SW	1"		6000#	524	174	102	95	115	122	√	√
ELB. 45 DEGR.	SW	1.1/4"		6000#	41	14	√	√	√	√	√	√
ELB. 45 DEGR.	SW	1.1/2"		6000#	87	29	29	23	√	√	√	√
ELB. 45 DEGR.	SW	2"		6000#	43	15	9	11	√	√	√	√
TEES	SW	1/2"		3000#	715	238	101	106	123	132	53	35
TEES	SW	3/4"		3000#	762	254	113	89	156	99	58	45
TEES	SW	1"		3000#	1025	342	221	189	203	256	114	36
TEES	SW	1.1/4"		3000#	56	19	48	52	34	56	32	52
TEES	SW	1.1/2"		3000#	248	83	106	87	89	103	45	23
TEES	SW	2"		3000#	159	53	42	49	52	55	28	17
TEES	SW	1/2"		6000#	325	108	110	102	88	76	√	√
TEES	SW	3/4"		6000#	309	103	123	115	92	82	√	√
TEES	SW	1"		6000#	514	172	214	205	113	154	√	√
TEES	SW	1.1/4"		6000#	37	14	51	53	√	√	√	√
TEES	SW	1.1/2"		6000#	89	29	104	108	√	√	√	√
TEES	SW	2"		6000#	53	18	53	46	√	√	√	√



2

√ = made from bar or forgings

# STOCK | DELIVERY PROGRAM



IML Nederland

TYPE		SIZE 1	SIZE 2	CLASS	A105/N	A350 LF2	A182 F11/2	A182 F22/3	A182 F304/L	A182 F316/L	A182 F321/H	A182 F51
RED. TEES	SW	3/4"	1/2"	3000#	258	86	114	✓	98	95	✓	✓
RED. TEES	SW	1"	1/2"	3000#	247	83	95	✓	88	84	✓	✓
RED. TEES	SW	1"	3/4"	3000#	268	89	87	✓	105	123	✓	✓
RED. TEES	SW	1.1/4"	1"	3000#	48	19	23	✓	23	24	✓	✓
RED. TEES	SW	1.1/2"	1/2"	3000#	74	26	48	✓	56	52	✓	✓
RED. TEES	SW	1.1/2"	3/4"	3000#	105	37	47	✓	61	67	✓	✓
RED. TEES	SW	1.1/2"	1"	3000#	231	77	59	✓	49	73	✓	✓
RED. TEES	SW	2"	1/2"	3000#	86	29	51	✓	54	68	✓	✓
RED. TEES	SW	2"	3/4"	3000#	74	26	47	✓	62	45	✓	✓
RED. TEES	SW	2"	1"	3000#	135	45	43	✓	57	49	✓	✓
RED. TEES	SW	2"	1.1/2"	3000#	109	37	48	✓	54	52	✓	✓
RED. TEES	SW	3/4"	1/2"	6000#	105	35	128	✓	78	87	✓	✓
RED. TEES	SW	1"	1/2"	6000#	121	42	104	✓	87	69	✓	✓
RED. TEES	SW	1"	3/4"	6000#	223	74	230	✓	99	127	✓	✓
RED. TEES	SW	1.1/4"	1"	6000#	23	21	23	✓	✓	✓	✓	✓
RED. TEES	SW	1.1/2"	1/2"	6000#	48	18	48	✓	✓	✓	✓	✓
RED. TEES	SW	1.1/2"	3/4"	6000#	41	19	52	✓	✓	✓	✓	✓
RED. TEES	SW	1.1/2"	1"	6000#	96	32	95	✓	✓	✓	✓	✓
RED. TEES	SW	2"	1/2"	6000#	54	19	60	✓	✓	✓	✓	✓
RED. TEES	SW	2"	3/4"	6000#	59	22	48	✓	✓	✓	✓	✓
RED. TEES	SW	2"	1"	6000#	48	24	51	✓	✓	✓	✓	✓
RED. TEES	SW	2"	1.1/2"	6000#	72	26	48	✓	✓	✓	✓	✓
HALF COUPLINGS	SW	1/2"		3000#	525	175	✓	✓	125	136	✓	✓
HALF COUPLINGS	SW	3/4"		3000#	498	166	✓	✓	134	149	✓	✓
HALF COUPLINGS	SW	1"		3000#	1035	345	✓	✓	176	167	✓	✓
HALF COUPLINGS	SW	1.1/4"		3000#	145	48	✓	✓	54	65	✓	✓
HALF COUPLINGS	SW	1.1/2"		3000#	265	89	✓	✓	75	69	✓	✓
HALF COUPLINGS	SW	2"		3000#	148	49	✓	✓	45	47	✓	✓
HALF COUPLINGS	SW	1/2"		6000#	260	86	✓	✓	65	67	✓	✓
HALF COUPLINGS	SW	3/4"		6000#	235	78	✓	✓	53	61	✓	✓
HALF COUPLINGS	SW	1"		6000#	465	155	✓	✓	77	99	✓	✓
HALF COUPLINGS	SW	1.1/4"		6000#	42	15	✓	✓	✓	✓	✓	✓
HALF COUPLINGS	SW	1.1/2"		6000#	135	45	✓	✓	✓	✓	✓	✓
HALF COUPLINGS	SW	2"		6000#	87	29	✓	✓	✓	✓	✓	✓
FULL COUPLINGS	SW	1/2"		3000#	520	173	55	64	123	135	45	✓
FULL COUPLINGS	SW	3/4"		3000#	478	159	58	77	117	133	48	✓
FULL COUPLINGS	SW	1"		3000#	1035	345	102	110	154	166	95	✓
FULL COUPLINGS	SW	1.1/4"		3000#	147	49	✓	✓	45	54	✓	✓
FULL COUPLINGS	SW	1.1/2"		3000#	309	103	23	35	45	65	23	✓
FULL COUPLINGS	SW	2"		3000#	205	69	12	18	32	55	11	✓
FULL COUPLINGS	SW	1/2"		6000#	247	83	46	61	56	68	✓	✓
FULL COUPLINGS	SW	3/4"		6000#	233	78	53	58	65	79	✓	✓
FULL COUPLINGS	SW	1"		6000#	485	162	105	89	99	70	✓	✓
FULL COUPLINGS	SW	1.1/4"		6000#	78	26	✓	✓	✓	✓	✓	✓
FULL COUPLINGS	SW	1.1/2"		6000#	146	49	25	32	✓	✓	✓	✓
FULL COUPLINGS	SW	2"		6000#	88	29	14	18	✓	✓	✓	✓

# STOCK | DELIVERY PROGRAM



IML Nederland

TYPE		SIZE 1	SIZE 2	CLASS	A105/N	A350 LF2	A182 F11/2	A182 F22/3	A182 F304/L	A182 F316/L	A182 F321/H	A182 F51
RED. COUPLINGS	SW	3/4"	1/2"	3000#	511	171	✓	✓	123	120	✓	✓
RED. COUPLINGS	SW	1"	1/2"	3000#	488	163	✓	✓	135	143	✓	✓
RED. COUPLINGS	SW	1"	3/4"	3000#	545	182	✓	✓	89	99	✓	✓
RED. COUPLINGS	SW	1.1/4"	1"	3000#	77	26	✓	✓	23	30	✓	✓
RED. COUPLINGS	SW	1.1/2"	1/2"	3000#	215	72	✓	✓	35	45	✓	✓
RED. COUPLINGS	SW	1.1/2"	3/4"	3000#	185	62	✓	✓	76	133	✓	✓
RED. COUPLINGS	SW	1.1/2"	1"	3000#	198	66	✓	✓	89	125	✓	✓
RED. COUPLINGS	SW	2"	3/4"	3000#	78	26	✓	✓	23	60	✓	✓
RED. COUPLINGS	SW	2"	1"	3000#	89	31	✓	✓	45	55	✓	✓
RED. COUPLINGS	SW	2"	1.1/2"	3000#	99	33	✓	✓	52	64	✓	✓
RED. COUPLINGS	SW	3/4"	1/2"	6000#	221	74	✓	✓	45	110	✓	✓
RED. COUPLINGS	SW	1"	1/2"	6000#	226	76	✓	✓	56	90	✓	✓
RED. COUPLINGS	SW	1"	3/4"	6000#	248	83	✓	✓	53	88	✓	✓
RED. COUPLINGS	SW	1.1/4"	1"	6000#	53	18	✓	✓	✓	✓	✓	✓
RED. COUPLINGS	SW	1.1/2"	1/2"	6000#	89	32	✓	✓	✓	✓	✓	✓
RED. COUPLINGS	SW	1.1/2"	3/4"	6000#	92	31	✓	✓	✓	✓	✓	✓
RED. COUPLINGS	SW	1.1/2"	1"	6000#	105	35	✓	✓	✓	✓	✓	✓
RED. COUPLINGS	SW	2"	3/4"	6000#	42	14	✓	✓	✓	✓	✓	✓
RED. COUPLINGS	SW	2"	1"	6000#	56	19	✓	✓	✓	✓	✓	✓
RED. COUPLINGS	SW	2"	1.1/2"	6000#	34	12	✓	✓	✓	✓	✓	✓
CAPS	SW	1/2"		3000#	522	174	55	66	123	145	61	✓
CAPS	SW	3/4"		3000#	478	159	74	64	134	140	58	✓
CAPS	SW	1"		3000#	945	315	53	45	143	98	89	✓
CAPS	SW	1.1/4"		3000#	65	22	✓	✓	✓	✓	✓	✓
CAPS	SW	1.1/2"		3000#	178	59	31	23	43	33	32	✓
CAPS	SW	2"		3000#	92	31	24	19	25	23	18	✓
CAPS	SW	1/2"		6000#	265	89	64	53	37	52	✓	✓
CAPS	SW	3/4"		6000#	245	82	48	54	42	60	✓	✓
CAPS	SW	1"		6000#	523	174	42	58	51	71	✓	✓
CAPS	SW	1.1/4"		6000#	41	14	✓	✓	✓	✓	✓	✓
CAPS	SW	1.1/2"		6000#	86	29	26	29	✓	✓	✓	✓
CAPS	SW	2"		6000#	41	14	19	22	✓	✓	✓	✓
UNION	SW	1/2"		3000#	99	33	23	21	56	49	✓	✓
UNION	SW	3/4"		3000#	105	35	26	29	62	52	✓	✓
UNION	SW	1"		3000#	123	41	47	53	111	133	✓	✓
UNION	SW	1.1/4"		3000#	42	14	✓	✓	✓	✓	✓	✓
UNION	SW	1.1/2"		3000#	74	25	22	26	35	45	✓	✓
UNION	SW	2"		3000#	59	19	9	15	23	35	✓	✓
UNION	SW	1/2"		6000#	43	14	✓	✓	22	19	✓	✓
UNION	SW	3/4"		6000#	47	16	✓	✓	18	23	✓	✓
UNION	SW	1"		6000#	94	32	✓	✓	23	34	✓	✓
UNION	SW	1.1/4"		6000#	23	12	✓	✓	✓	✓	✓	✓
UNION	SW	1.1/2"		6000#	41	14	✓	✓	✓	✓	✓	✓
UNION	SW	2"		6000#	19	8	✓	✓	✓	✓	✓	✓



# STOCK | DELIVERY PROGRAM



IML Nederland

TYPE		SIZE 1	SIZE 2	CLASS	A105/N	A350 LF2	A105 HDG	A182 F304/L	A182 F316/L
ELB. 90 DEGR.	NPT	1/2"		3000#	1015	253	329	101	126
ELB. 90 DEGR.	NPT	3/4"		3000#	958	239	310	95	119
ELB. 90 DEGR.	NPT	1"		3000#	2105	526	683	188	236
ELB. 90 DEGR.	NPT	1.1/4"		3000#	478	119	√	√	√
ELB. 90 DEGR.	NPT	1.1/2"		3000#	740	185	240	73	92
ELB. 90 DEGR.	NPT	2"		3000#	501	126	163	51	63
ELB. 90 DEGR.	NPT	1/2"		6000#	487	121	√	√	√
ELB. 90 DEGR.	NPT	3/4"		6000#	456	114	√	√	√
ELB. 90 DEGR.	NPT	1"		6000#	897	224	√	√	√
ELB. 90 DEGR.	NPT	1.1/4"		6000#	159	42	√	√	√
ELB. 90 DEGR.	NPT	1.1/2"		6000#	435	109	√	√	√
ELB. 90 DEGR.	NPT	2"		6000#	209	53	√	√	√
ELB. 45 DEGR.	NPT	1/2"		3000#	478	119	154	47	59
ELB. 45 DEGR.	NPT	3/4"		3000#	423	106	137	42	53
ELB. 45 DEGR.	NPT	1"		3000#	875	219	284	87	109
ELB. 45 DEGR.	NPT	1.1/4"		3000#	165	42	√	√	√
ELB. 45 DEGR.	NPT	1.1/2"		3000#	425	106	137	42	53
ELB. 45 DEGR.	NPT	2"		3000#	187	47	61	19	24
ELB. 45 DEGR.	NPT	1/2"		6000#	215	54	√	√	√
ELB. 45 DEGR.	NPT	3/4"		6000#	198	49	√	√	√
ELB. 45 DEGR.	NPT	1"		6000#	489	122	√	√	√
ELB. 45 DEGR.	NPT	1.1/4"		6000#	87	22	√	√	√
ELB. 45 DEGR.	NPT	1.1/2"		6000#	241	61	√	√	√
ELB. 45 DEGR.	NPT	2"		6000#	165	42	√	√	√
TEES	NPT	1/2"		3000#	615	153	198	61	76
TEES	NPT	3/4"		3000#	525	131	170	52	65
TEES	NPT	1"		3000#	1034	258	335	103	129
TEES	NPT	1.1/4"		3000#	147	37	√	√	√
TEES	NPT	1.1/2"		3000#	267	68	88	27	34
TEES	NPT	2"		3000#	142	36	47	14	18
TEES	NPT	1/2"		6000#	245	61	√	√	√
TEES	NPT	3/4"		6000#	215	54	√	√	√
TEES	NPT	1"		6000#	495	124	√	√	√
TEES	NPT	1.1/4"		6000#	49	13	√	√	√
TEES	NPT	1.1/2"		6000#	103	26	√	√	√
TEES	NPT	2"		6000#	52	13	√	√	√



# STOCK | DELIVERY PROGRAM



IML Nederland

TYPE		SIZE 1	SIZE 2	CLASS	A105/N	A350 LF2	A105 HDG	A182 F304/L	A182 F316/L
RED. TEES	NPT	3/4"	1/2"	3000#	510	√	√	√	√
RED. TEES	NPT	1"	1/2"	3000#	518	√	√	√	√
RED. TEES	NPT	1"	3/4"	3000#	510	√	√	√	√
RED. TEES	NPT	1.1/4"	1"	3000#	104	√	√	√	√
RED. TEES	NPT	1.1/2"	1/2"	3000#	156	√	√	√	√
RED. TEES	NPT	1.1/2"	3/4"	3000#	158	√	√	√	√
RED. TEES	NPT	1.1/2"	1"	3000#	259	√	√	√	√
RED. TEES	NPT	2"	1/2"	3000#	103	√	√	√	√
RED. TEES	NPT	2"	3/4"	3000#	109	√	√	√	√
RED. TEES	NPT	2"	1"	3000#	156	√	√	√	√
RED. TEES	NPT	2"	1.1/2"	3000#	142	√	√	√	√
RED. TEES	NPT	3/4"	1/2"	6000#	258	√	√	√	√
RED. TEES	NPT	1"	1/2"	6000#	262	√	√	√	√
RED. TEES	NPT	1"	3/4"	6000#	211	√	√	√	√
RED. TEES	NPT	1.1/4"	1"	6000#	51	√	√	√	√
RED. TEES	NPT	1.1/2"	1/2"	6000#	108	√	√	√	√
RED. TEES	NPT	1.1/2"	3/4"	6000#	98	√	√	√	√
RED. TEES	NPT	1.1/2"	1"	6000#	145	√	√	√	√
RED. TEES	NPT	2"	1/2"	6000#	168	√	√	√	√
RED. TEES	NPT	2"	3/4"	6000#	104	√	√	√	√
RED. TEES	NPT	2"	1"	6000#	96	√	√	√	√
RED. TEES	NPT	2"	1.1/2"	6000#	87	√	√	√	√
HALF COUPLINGS	NPT	1/2"		3000#	1038	259	336	103	129
HALF COUPLINGS	NPT	3/4"		3000#	987	246	319	98	123
HALF COUPLINGS	NPT	1"		3000#	1558	389	505	155	194
HALF COUPLINGS	NPT	1.1/4"		3000#	208	52	√	√	√
HALF COUPLINGS	NPT	1.1/2"		3000#	259	64	83	25	32
HALF COUPLINGS	NPT	2"		3000#	156	39	51	16	21
HALF COUPLINGS	NPT	1/2"		6000#	519	129	√	√	√
HALF COUPLINGS	NPT	3/4"		6000#	514	126	√	√	√
HALF COUPLINGS	NPT	1"		6000#	779	194	√	√	√
HALF COUPLINGS	NPT	1.1/4"		6000#	104	√	√	√	√
HALF COUPLINGS	NPT	1.1/2"		6000#	156	√	√	√	√
HALF COUPLINGS	NPT	2"		6000#	101	√	√	√	√
FULL COUPLINGS	NPT	1/2"		3000#	1035	258	335	103	129
FULL COUPLINGS	NPT	3/4"		3000#	1087	271	352	108	135
FULL COUPLINGS	NPT	1"		3000#	1560	393	511	156	196
FULL COUPLINGS	NPT	1.1/4"		3000#	210	53	√	√	√
FULL COUPLINGS	NPT	1.1/2"		3000#	240	62	80	24	31
FULL COUPLINGS	NPT	2"		3000#	145	36	47	14	18
FULL COUPLINGS	NPT	1/2"		6000#	534	133	√	√	√
FULL COUPLINGS	NPT	3/4"		6000#	510	128	√	√	√
FULL COUPLINGS	NPT	1"		6000#	801	206	√	√	√
FULL COUPLINGS	NPT	1.1/4"		6000#	107	28	√	√	√
FULL COUPLINGS	NPT	1.1/2"		6000#	160	42	√	√	√
FULL COUPLINGS	NPT	2"		6000#	87	22	√	√	√

# STOCK | DELIVERY PROGRAM



IML Nederland

TYPE		SIZE 1	SIZE 2	CLASS	A105/N	A350 LF2	A105 HDG	A182 F304/L	A182 F316/L
CAPS	NPT	1/2"		3000#	1068	267	347	106	133
CAPS	NPT	3/4"		3000#	1070	261	339	103	129
CAPS	NPT	1"		3000#	1603	402	522	161	201
CAPS	NPT	1.1/4"		3000#	214	54	√	√	√
CAPS	NPT	1.1/2"		3000#	267	68	88	27	34
CAPS	NPT	2"		3000#	145	36	47	14	18
CAPS	NPT	1/2"		6000#	267	66	√	√	√
CAPS	NPT	3/4"		6000#	248	63	√	√	√
CAPS	NPT	1"		6000#	234	58	√	√	√
CAPS	NPT	1.1/4"		6000#	53	√	√	√	√
CAPS	NPT	1.1/2"		6000#	106	√	√	√	√
CAPS	NPT	2"		6000#	58	√	√	√	√
HEX HEAD PLUG	NPT	1/2"		3/6000#	1087	272	353	108	136
HEX HEAD PLUG	NPT	3/4"		3/6000#	1045	261	339	103	129
HEX HEAD PLUG	NPT	1"		3/6000#	1630	408	530	163	204
HEX HEAD PLUG	NPT	1.1/4"		3/6000#	217	54	√	√	√
HEX HEAD PLUG	NPT	1.1/2"		3/6000#	272	68	89	27	34
HEX HEAD PLUG	NPT	2"		3/6000#	163	41	53	18	23
ROUND HEAD PLUG	NPT	1/2"		3/6000#	1015	253	√	√	√
ROUND HEAD PLUG	NPT	3/4"		3/6000#	1034	258	√	√	√
ROUND HEAD PLUG	NPT	1"		3/6000#	1522	381	√	√	√
ROUND HEAD PLUG	NPT	1.1/4"		3/6000#	203	51	√	√	√
ROUND HEAD PLUG	NPT	1.1/2"		3/6000#	254	63	√	√	√
ROUND HEAD PLUG	NPT	2"		3/6000#	153	38	√	√	√
UNIONS	NPT	1/2"		3000#	254	63	81	26	32
UNIONS	NPT	3/4"		3000#	235	58	75	23	29
UNIONS	NPT	1"		3000#	508	127	165	51	63
UNIONS	NPT	1.1/4"		3000#	52	13	√	√	√
UNIONS	NPT	1.1/2"		3000#	154	38	49	15	19
UNIONS	NPT	2"		3000#	102	26	33	10	13
UNIONS	NPT	1/2"		6000#	152	38	√	√	√
UNIONS	NPT	3/4"		6000#	135	34	√	√	√
UNIONS	NPT	1"		6000#	222	56	√	√	√
UNIONS	NPT	1.1/4"		6000#	26	√	√	√	√
UNIONS	NPT	1.1/2"		6000#	76	√	√	√	√
UNIONS	NPT	2"		6000#	51	√	√	√	√

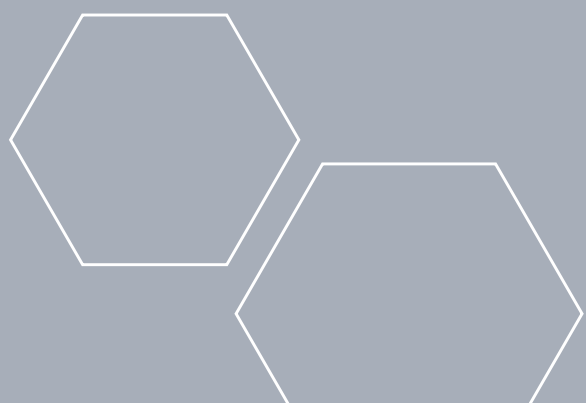

# STOCK | DELIVERY PROGRAM



IML Nederland

TYPE		SIZE 1	SIZE 2	CLASS	A105/N	A350 LF2	A105 HDG	A182 F304/L	A182 F316/L
HEX NIPPLE	NPT	1/2"		3000#	987	246	319	98	123
HEX NIPPLE	NPT	3/4"		3000#	1025	256	332	102	128
HEX NIPPLE	NPT	1"		3000#	1481	370	481	148	185
HEX NIPPLE	NPT	1.1/4"		3000#	197	49	✓	✓	✓
HEX NIPPLE	NPT	1.1/2"		3000#	247	62	81	24	31
HEX NIPPLE	NPT	2"		3000#	148	37	48	15	19
HEX NIPPLE	NPT	1/2"		6000#	493	123	✓	✓	✓
HEX NIPPLE	NPT	3/4"		6000#	478	119	✓	✓	✓
HEX NIPPLE	NPT	1"		6000#	955	238	✓	✓	✓
HEX NIPPLE	NPT	1.1/4"		6000#	49	✓	✓	✓	✓
HEX NIPPLE	NPT	1.1/2"		6000#	148	✓	✓	✓	✓
HEX NIPPLE	NPT	2"		6000#	93	✓	✓	✓	✓
RED. HEX NIPPLE	NPT	3/4"	1/2"	3000#	488	122	✓	48	61
RED. HEX NIPPLE	NPT	1"	1/2"	3000#	465	116	✓	46	58
RED. HEX NIPPLE	NPT	1"	3/4"	3000#	520	124	✓	49	62
RED. HEX NIPPLE	NPT	1.1/4"	1"	3000#	98	24	✓	✓	✓
RED. HEX NIPPLE	NPT	1.1/2"	1/2"	3000#	148	37	✓	15	19
RED. HEX NIPPLE	NPT	1.1/2"	3/4"	3000#	155	38	✓	16	21
RED. HEX NIPPLE	NPT	1.1/2"	1"	3000#	246	62	✓	24	31
RED. HEX NIPPLE	NPT	2"	1/2"	3000#	96	24	✓	10	12
RED. HEX NIPPLE	NPT	2"	3/4"	3000#	88	22	✓	12	15
RED. HEX NIPPLE	NPT	2"	1"	3000#	63	16	✓	11	13
RED. HEX NIPPLE	NPT	2"	1.1/2"	3000#	42	10	✓	8	11
RED. HEX NIPPLE	NPT	3/4"	1/2"	6000#	248	62	✓	✓	✓
RED. HEX NIPPLE	NPT	1"	1/2"	6000#	223	55	✓	✓	✓
RED. HEX NIPPLE	NPT	1"	3/4"	6000#	268	67	✓	✓	✓
RED. HEX NIPPLE	NPT	1.1/4"	1"	6000#	19	✓	✓	✓	✓
RED. HEX NIPPLE	NPT	1.1/2"	1/2"	6000#	55	✓	✓	✓	✓
RED. HEX NIPPLE	NPT	1.1/2"	3/4"	6000#	52	✓	✓	✓	✓
RED. HEX NIPPLE	NPT	1.1/2"	1"	6000#	49	✓	✓	✓	✓
RED. HEX NIPPLE	NPT	2"	1/2"	6000#	23	✓	✓	✓	✓
RED. HEX NIPPLE	NPT	2"	3/4"	6000#	17	✓	✓	✓	✓
RED. HEX NIPPLE	NPT	2"	1"	6000#	13	✓	✓	✓	✓
RED. HEX NIPPLE	NPT	2"	1.1/2"	6000#	18	✓	✓	✓	✓





# STOCK I DELIVERY PROGRAM



IML Nederland

TYPE		SIZE 1	SIZE 2	CLASS	A105/N	A350 LF2	A105 HDG	A182 F304/L	A182 F316/L
RED. COUPLINGS	NPT	3/4"	1/2"	3000#	490	122	√	48	61
RED. COUPLINGS	NPT	1"	1/2"	3000#	488	140	√	56	71
RED. COUPLINGS	NPT	1"	3/4"	3000#	473	118	√	47	59
RED. COUPLINGS	NPT	1.1/4"	1"	3000#	98	24	√	√	√
RED. COUPLINGS	NPT	1.1/2"	1/2"	3000#	147	36	√	15	19
RED. COUPLINGS	NPT	1.1/2"	3/4"	3000#	156	39	√	16	21
RED. COUPLINGS	NPT	1.1/2"	1"	3000#	245	62	√	26	33
RED. COUPLINGS	NPT	2"	1/2"	3000#	79	19	√	9	11
RED. COUPLINGS	NPT	2"	3/4"	3000#	88	22	√	11	13
RED. COUPLINGS	NPT	2"	1"	3000#	71	17	√	14	15
RED. COUPLINGS	NPT	2"	1.1/2"	3000#	48	12	√	18	14
RED. COUPLINGS	NPT	3/4"	1/2"	6000#	238	59	√	√	√
RED. COUPLINGS	NPT	1"	1/2"	6000#	247	61	√	√	√
RED. COUPLINGS	NPT	1"	3/4"	6000#	265	66	√	√	√
RED. COUPLINGS	NPT	1.1/4"	1"	6000#	19	√	√	√	√
RED. COUPLINGS	NPT	1.1/2"	1/2"	6000#	47	√	√	√	√
RED. COUPLINGS	NPT	1.1/2"	3/4"	6000#	49	√	√	√	√
RED. COUPLINGS	NPT	1.1/2"	1"	6000#	53	√	√	√	√
RED. COUPLINGS	NPT	2"	1/2"	6000#	61	√	√	√	√
RED. COUPLINGS	NPT	2"	3/4"	6000#	55	√	√	√	√
RED. COUPLINGS	NPT	2"	1"	6000#	61	√	√	√	√
RED. COUPLINGS	NPT	2"	1.1/2"	6000#	48	√	√	√	√
RED. BUSHINGS M/F	NPT	3/4"	1/2"	3/6000#	954	238	√	95	119
RED. BUSHINGS M/F	NPT	1"	1/2"	3/6000#	1431	358	√	143	179
RED. BUSHINGS M/F	NPT	1"	3/4"	3/6000#	1652	413	√	165	206
RED. BUSHINGS M/F	NPT	1.1/4"	1"	3/6000#	191	48	√	√	√
RED. BUSHINGS M/F	NPT	1.1/2"	1/2"	3/6000#	193	52	√	21	26
RED. BUSHINGS M/F	NPT	1.1/2"	3/4"	3/6000#	238	59	√	23	29
RED. BUSHINGS M/F	NPT	1.1/2"	1"	3/6000#	242	63	√	26	32
RED. BUSHINGS M/F	NPT	2"	1/2"	3/6000#	143	35	√	14	18
RED. BUSHINGS M/F	NPT	2"	3/4"	3/6000#	165	41	√	16	20
RED. BUSHINGS M/F	NPT	2"	1"	3/6000#	95	23	√	18	12
RED. BUSHINGS M/F	NPT	2"	1.1/2"	3/6000#	97	28	√	19	14

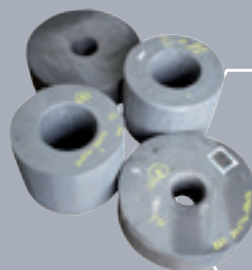

# STOCK | DELIVERY PROGRAM

## FORGINGS



TYPE	SIZE		A105/N	A350 LF2	A182 F5	A182 F1/1/2	A182 F22/3	A182 F91	A182 F304/L	A182 F316/L	A182 F321/H	A182 F44	A182 F51	A182 F53
ELB. 90 DEGR.	1/2"	D33	✓	✓	✓	✓	✓	✓	✓	✓	✓	✓	✓	✓
ELB. 90 DEGR.	3/4"	D38	✓	✓	✓	✓	✓	✓	✓	✓	✓	✓	✓	✓
ELB. 90 DEGR.	1"	D46	✓	✓	✓	✓	✓	✓	✓	✓	✓	✓	✓	✓
ELB. 90 DEGR.	1.1/4"	D56	✓	✓	✓	✓	✓	✓	✓	✓	✓	✓	✓	✓
ELB. 90 DEGR.	1.1/2"	D62	✓	✓	✓	✓	✓	✓	✓	✓	✓	✓	✓	✓
ELB. 90 DEGR.	2"	D76	✓	✓	✓	✓	✓	✓	✓	✓	✓	✓	✓	✓
ELB. 90 DEGR.		D84	✓	✓	✓	✓	✓	✓	✓	✓	✓	✓	✓	✓
ELB. 90 DEGR.		D92	✓	✓	✓									
ELB. 45 DEGR.	1/2"	D33	✓	✓	✓	✓	✓	✓	✓	✓	✓	✓	✓	✓
ELB. 45 DEGR.	3/4"	D38	✓	✓	✓	✓	✓	✓	✓	✓	✓	✓	✓	✓
ELB. 45 DEGR.	1"	D46	✓	✓	✓	✓	✓	✓	✓	✓	✓	✓	✓	✓
ELB. 45 DEGR.	1.1/4"	D56	✓	✓	✓	✓	✓	✓	✓	✓	✓	✓	✓	✓
ELB. 45 DEGR.	1.1/2"	D62	✓	✓	✓	✓	✓	✓	✓	✓	✓	✓	✓	✓
ELB. 45 DEGR.	2"	D76	✓	✓	✓	✓	✓	✓	✓	✓	✓	✓	✓	✓
ELB. 45 DEGR.		D84	✓	✓	✓	✓	✓	✓	✓	✓	✓	✓	✓	✓
ELB. 45 DEGR.		D92	✓	✓										
TEES	1/2"	D33	✓	✓	✓	✓	✓	✓	✓	✓	✓	✓	✓	✓
TEES	3/4"	D38	✓	✓	✓	✓	✓	✓	✓	✓	✓	✓	✓	✓
TEES	1"	D46	✓	✓	✓	✓	✓	✓	✓	✓	✓	✓	✓	✓
TEES	1.1/4"	D56	✓	✓	✓	✓	✓	✓	✓	✓	✓	✓	✓	✓
TEES	1.1/2"	D62	✓	✓	✓	✓	✓	✓	✓	✓	✓	✓	✓	✓
TEES	2"	D76	✓	✓	✓	✓	✓	✓	✓	✓	✓	✓	✓	✓
TEES		D84	✓	✓	✓	✓	✓	✓	✓	✓	✓	✓	✓	✓
TEES		D92	✓	✓	✓									



# STOCK | DELIVERY PROGRAM



IML Nederland

## OUTLET FORGINGS

SUITABLE FOR BW - SW - THREAD OUTLETS 3000# / 6000# / 9000#

SIZE	A105/N	A350 LF2	A182 F11/2	A182 F22/3	A350 LF3	A182 F304/L	A182 F316/L	A182 F321/H	A182 F51
1/2"	✓	✓	✓	✓	✓	✓	✓	✓	✓
3/4"	✓	✓	✓	✓	✓	✓	✓	✓	✓
1"	✓	✓	✓	✓	✓	✓	✓	✓	✓
1.1/4"	✓	✓	✓	✓	✓	✓	✓	✓	✓
1.1/2"	✓	✓	✓	✓	✓	✓	✓	✓	✓
2"	✓	✓	✓	✓	✓	✓	✓	✓	✓
3"	✓	✓	✓	✓	✓	✓	✓	✓	
4"	✓	✓	✓	✓	✓	✓	✓	✓	
6"	✓	✓	✓		✓	✓	✓		
8"	✓	✓	✓		✓	✓	✓		
10"	✓	✓							
12"	✓	✓							





**IML Nederland**

Zinkstraat 33  
4823 AD Breda  
The Netherlands

Phone +31 (0) 76 850 5030  
Fax +31 (0) 76 850 5039  
[info@iml-nederland.nl](mailto:info@iml-nederland.nl)  
[www.iml-nederland.nl](http://www.iml-nederland.nl)